

Ruckus SpeedFlex Wireless Assessment Tool - S.W.A.T. - is a wireless performance testing and site survey companion. Based on the open source performance test tool, SpeedFlex, this comprehensive yet easy to use application from Ruckus gives users a simple way to collect site performance data. It can be used to validate the performance of an existing installation, or assist in planning a new site deployment. Simply connect to a SpeedFlex server – such as a Ruckus ZoneFlex AP or ZoneDirector - and you can instantly test network throughput and coverage. Easily import floorplans from Dropbox or snap a quick photo using the camera, and you can plot results with a graphical representation of your actual environment. The Ruckus S.W.A.T. app includes these powerful features:

- Throughput based analysis
- Project and Survey creation
- Import floorplans via popular cloud service Dropbox
- Snap a quick photo with the built in tablet camera
- Locate floorplan from photo gallery
- Scale floorplan to make heat map more accurate
- Choose from most common Ruckus AP's
- Test throughput by UDP/TCP, uplink and downlink
- Generate email with throughput and/or heatmap results
- Upload heat map results to Dropbox



Main project screen

Click the + to create a new master project. This can hold multiple surveys. Give it a name and description (optional).

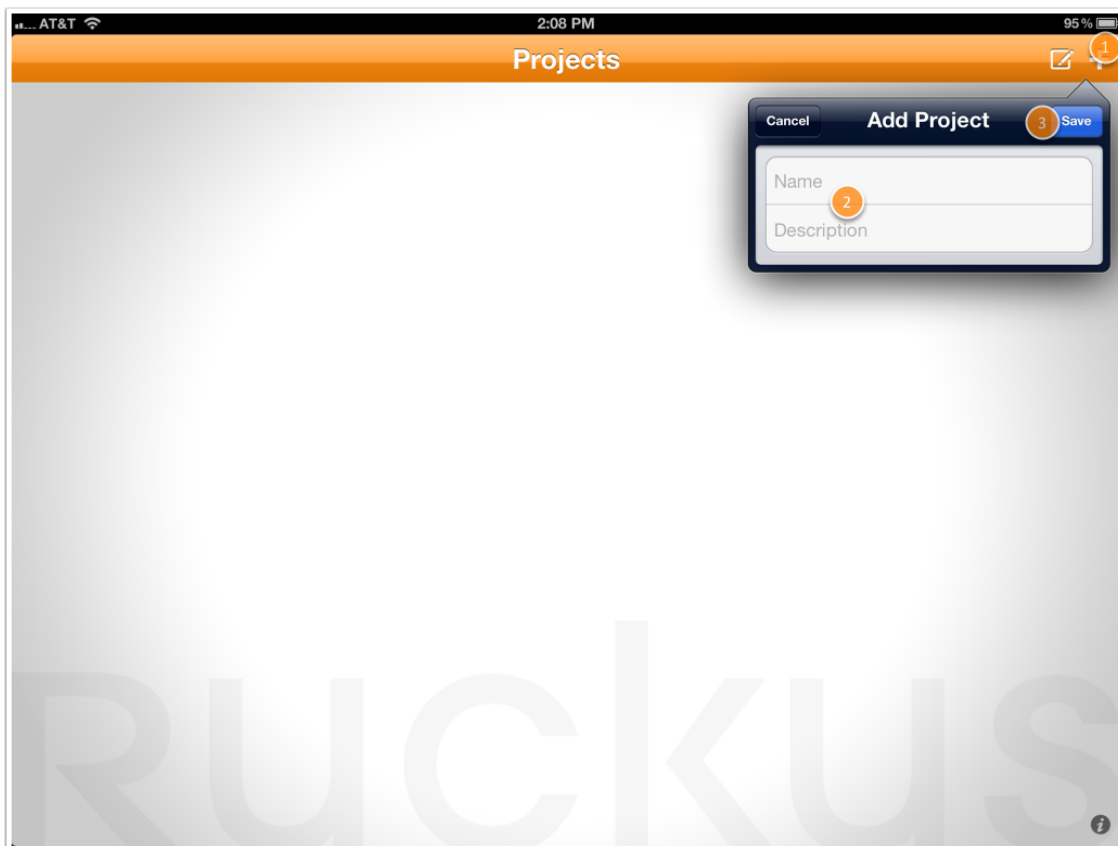

Project tile

Your projects will be listed as tiles with the name and description. You can delete them by clicking the Edit box.

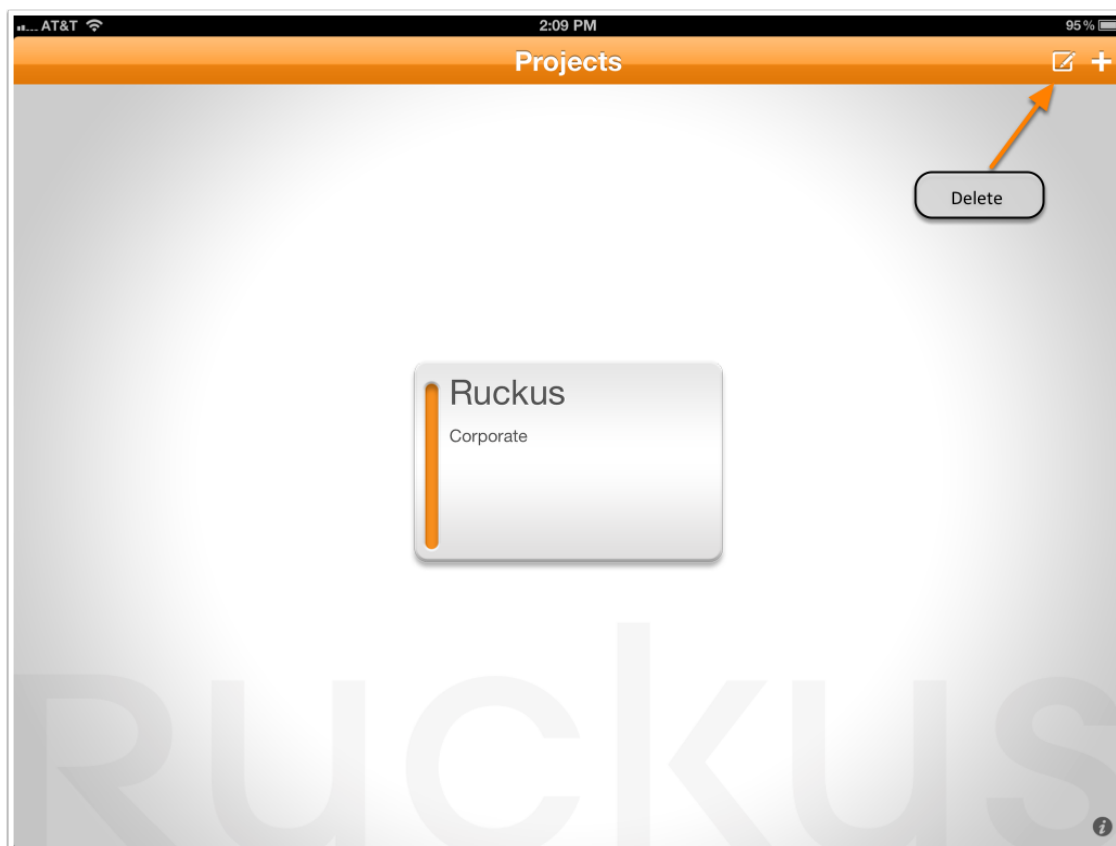

Survey tile with thumbnail

After you have imported an image, it will display as a thumbnail next to survey tile

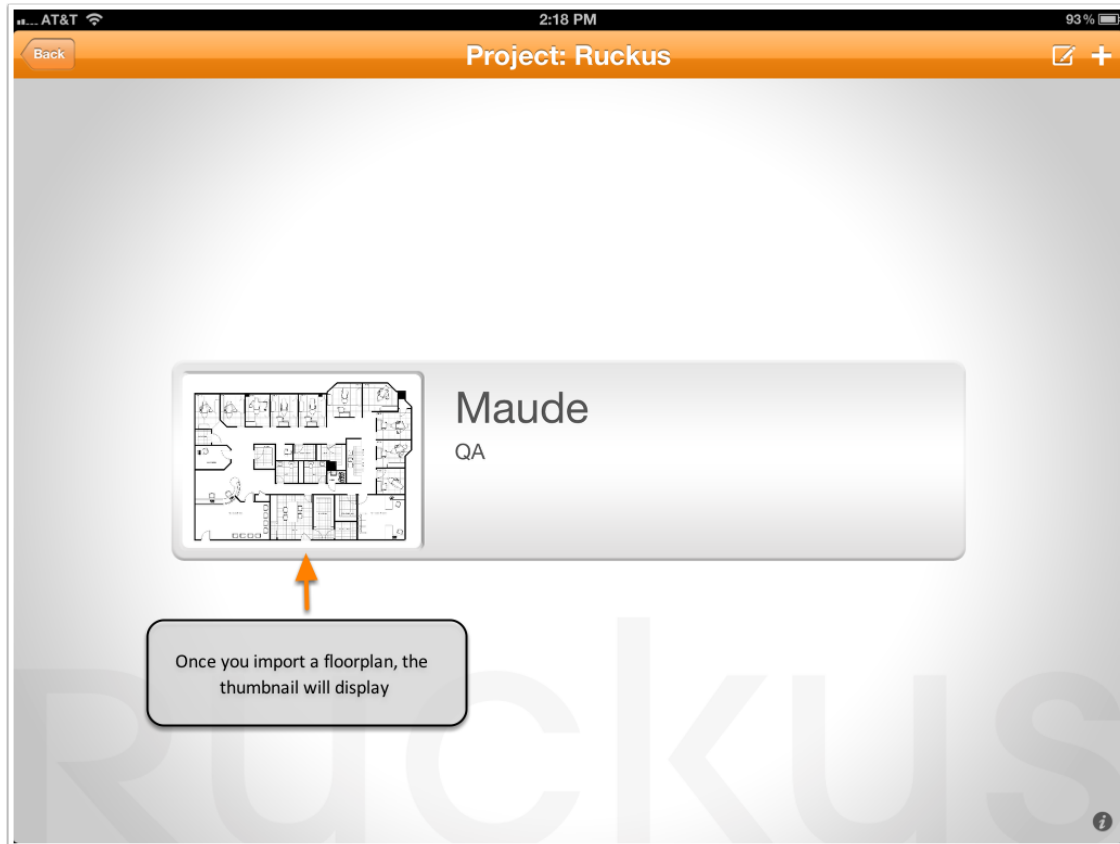

Add floorplan

Main view prior to setting a floor plan



Settings

Enter the IP address of the SpeedFlex server, adjust the test duration via the slider and choose the proper test metrics.

These settings apply across the duration of the testing unless you modify. For example, if you want to test a few points with TCP/uplink and then some with UDP/uplink, just click settings and adjust then.



Settings / Estimated Area (Confidence value)

Touch the information button next to the value to get more details.



Dropbox authorization

You will need to have Dropbox loaded onto the iPad to use this feature.

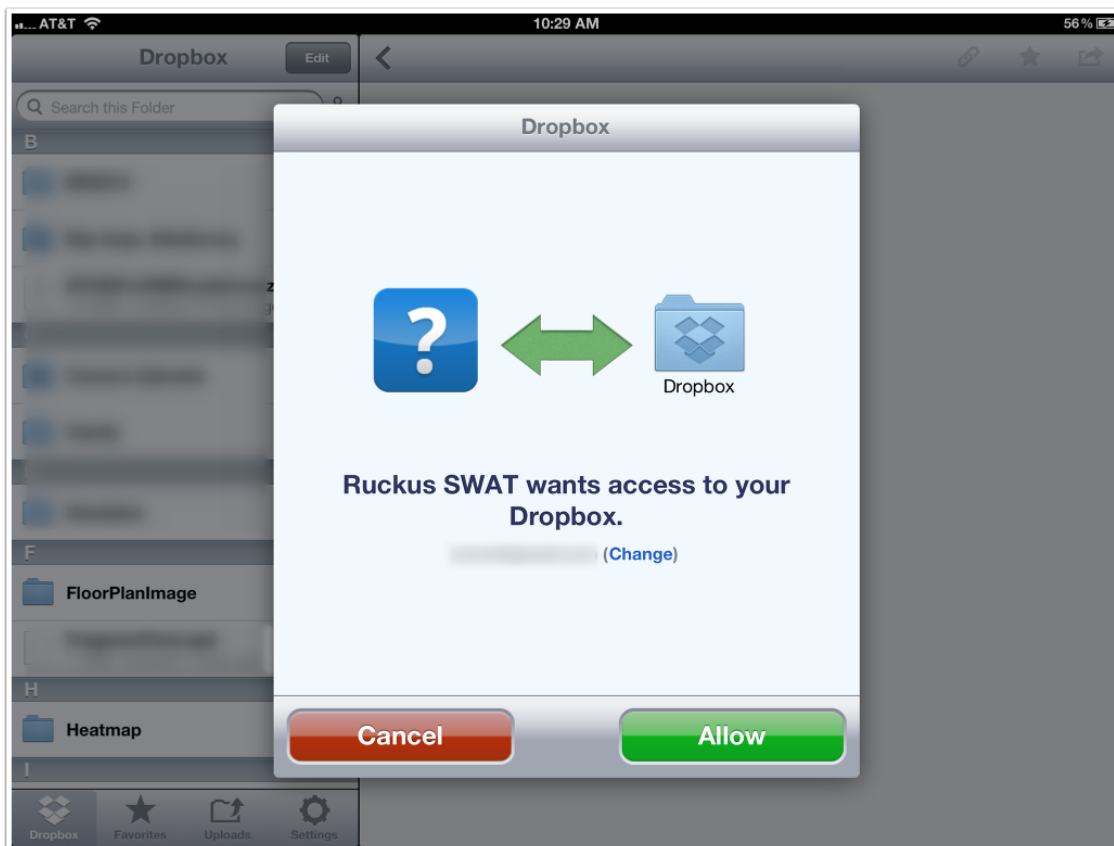

AP selection

You select and touch the location on the map where the AP is located. This is not required and has no impact on the output of the testing. Its for reference only.



Add survey point

The survey points are the locations where you are conducting the tests. Its suggested to be stationary during the testing cycle. Simply click on the map, when you are at that point, and give the label a name (optional). You can keep dropping survey points until you click Done.



SpeedFlex running

When you click the blue survey point it will kick off a zap run for the duration specified on the Settings panel. Yellow indicates test in progress and once completed will be green.



Complete SpeedFlex test

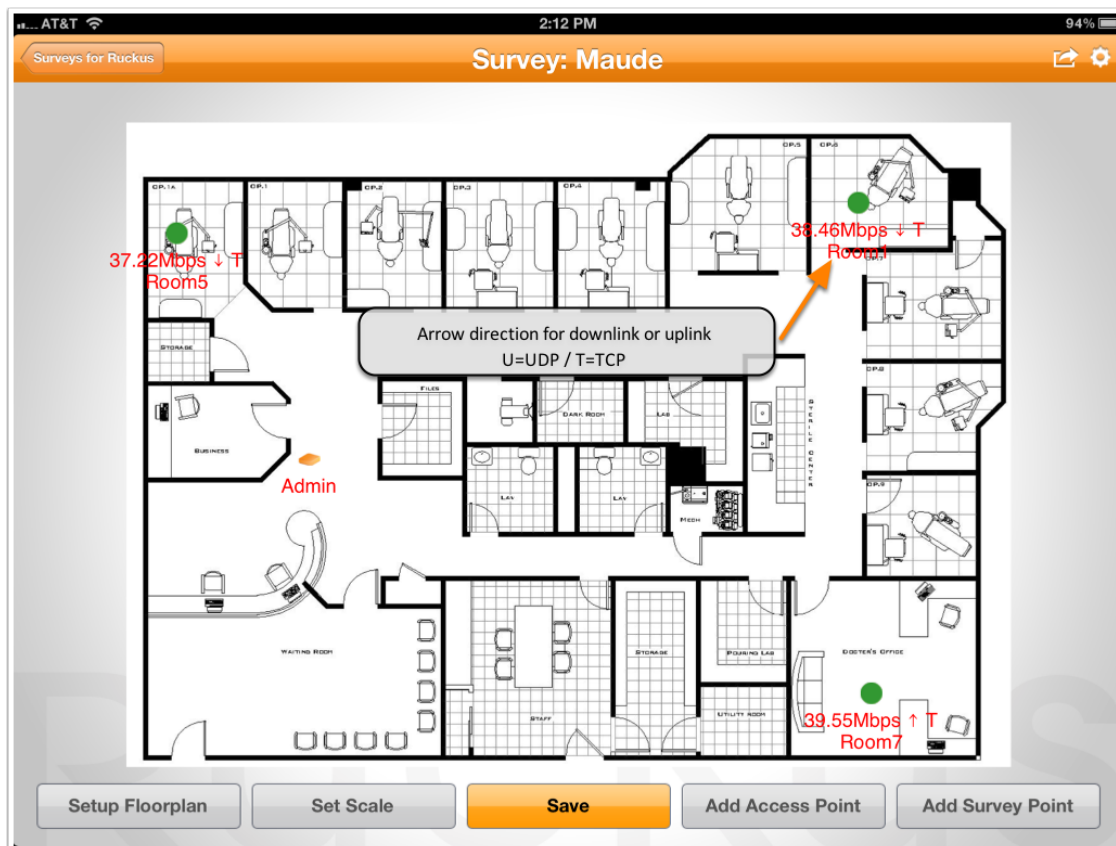

Output options

You can generate a heatmap or email the results

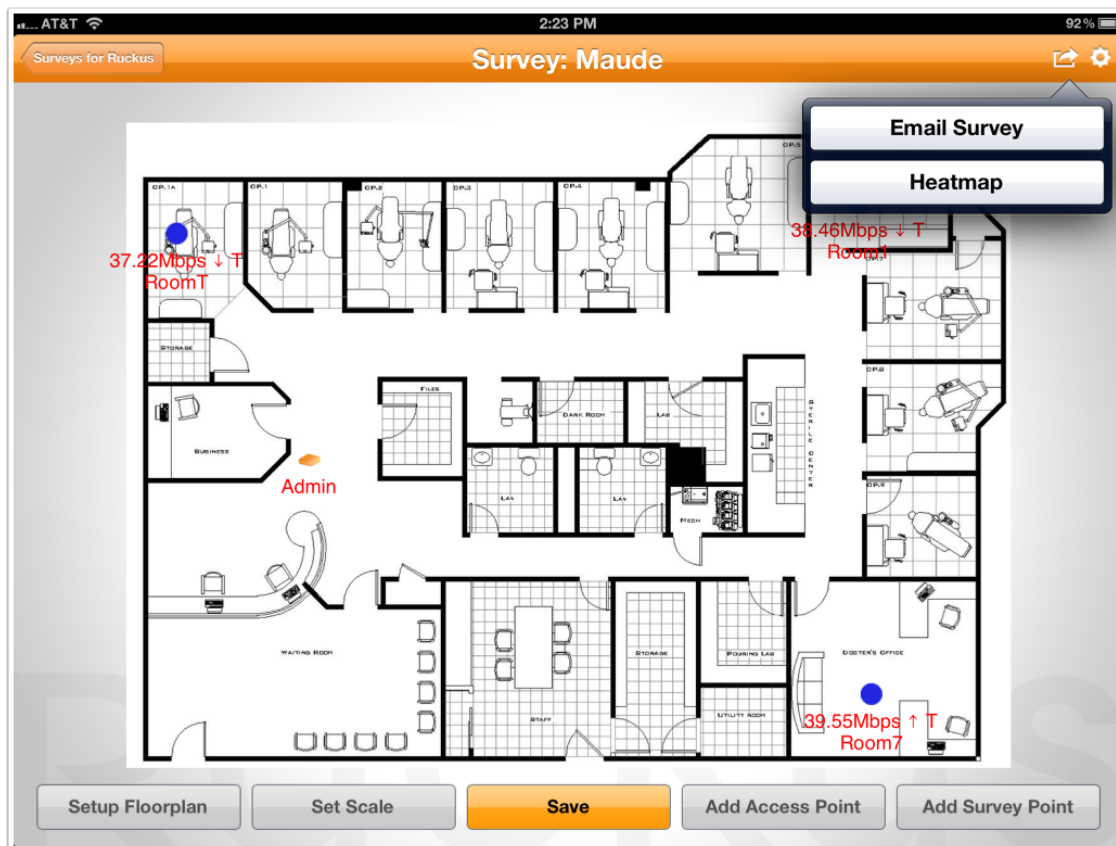

Email results

You can generate an email containing the throughput results

